

UPPER DECK
2ND DECK
3RD DECK
4TH DECK
TANK TOP

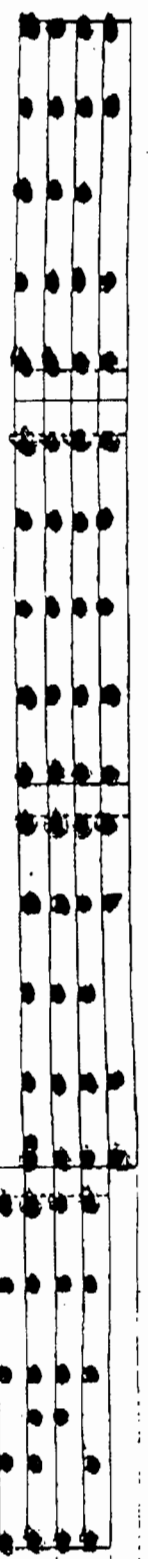

IND S
R006644

MV "LINCOLN UNIVERSAL"
COLOMBO

OFF. NO.: 1110 BHP : 10670
GROSS : 10298 NET : 4653

MV Lincoln Universal
CB

NO. 1A REF. CARGO HOLD

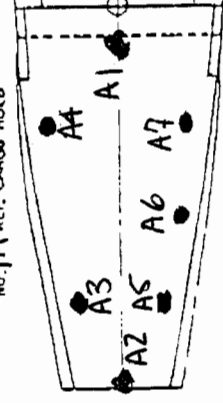

R DECK

NO. 1B REF. CARGO HOLD

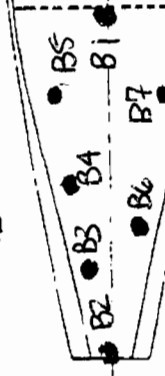

91969939870

NO. 2A REF. CARGO HOLD



NO. 3A REF. CARGO HOLD

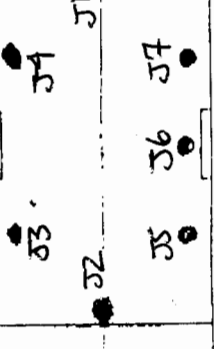

NO. 4A REF. CARGO HOLD

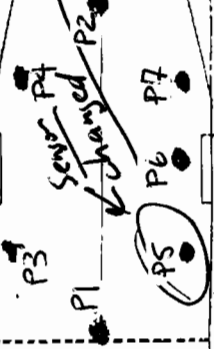

NO. 1C REF. CARGO HOLD

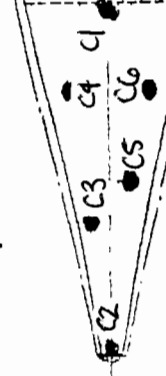

DECK

NO. 2B REF. CARGO HOLD

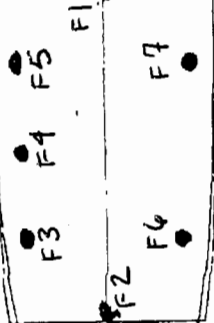

NO. 3B REF. CARGO HOLD

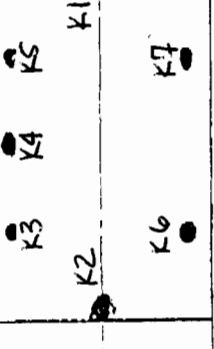

NO. 4B REF. CARGO HOLD

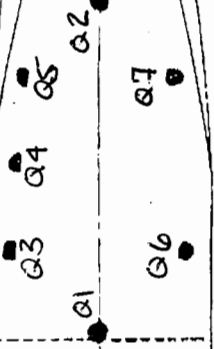

NO. 1D REF. CARGO HOLD

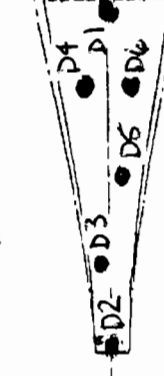

DECK

NO. 2C REF. CARGO HOLD

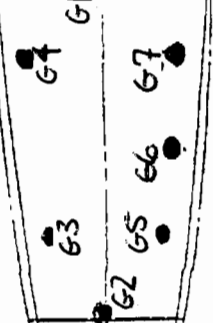

NO. 3C REF. CARGO HOLD

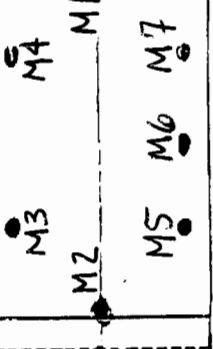

NO. 4C REF. CARGO HOLD

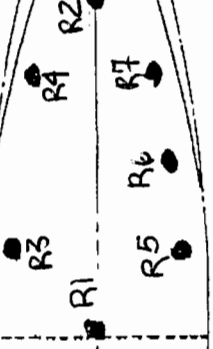

NO. 2D REF. CARGO HOLD

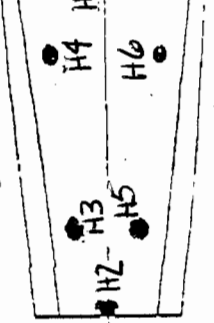

NO. 3D REF. CARGO HOLD

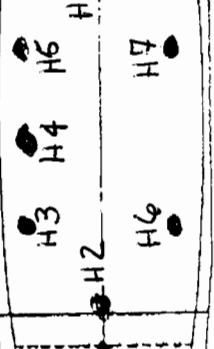

NO. 4D REF. CARGO HOLD

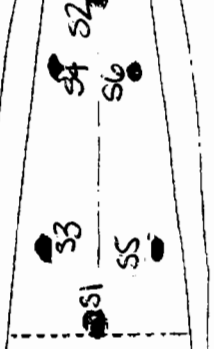

K TOP

T-525 P. 03/09 J06-053

From: USDA APHIS OXFORD

JAN-10-97 15:30

● FIXED SET
○ NON-FIXED

Teno
Hull No. 1300